

Specifications

Compatibility	TeleAlarm
Operating Frequency	869.2125 MHz
Dimensions	Sleep Advanced - L950 x W260 x D20 mm Sit Advanced - L440 x W390 x D20 mm (at widest points)
Input	1x Custom input
Power Supply	Renata CR2477 Coin Cell battery (User replaceable)
Battery Life	2 years under the following conditions - 5 alarms transmission per day
Wireless Range	Up to 600m line of sight
Compliance	UKCA / CE / RoHS 2 / RED
Presence Transmission	Every 20 hours
Warranty	12 months

Battery Replacement

It is important that a Renata CR2477N Coin Cell battery should be used to ensure maximum battery life and accurate low battery notifications. Please note the polarity markings within the battery compartment and ensure that the battery is inserted correctly. To make it easier to open the unit and change the battery, it is recommended to disconnect the Detect Mini from the pad.  
**Tip:** Ensure the switch cover stays in place when opening and closing the Detect Mini.

Pad Replacement

The pad should be replaced after 12 months of use. There is no expiry date for the Detect Mini, providing the batteries are replaced and it is still in good working order.

Packing for shipment

The equipment containing cells or batteries must be packed in strong rigid packaging and must be secured against movement within the outer packaging to prevent accidental activation. The sender's name and return address must be clearly visible on the outer packaging.

Safety

Do not dismantle or alter the unit. Do not open the case, unless replacing battery. Indoor use in dry location only.

Disposal

All electronic waste should be disposed of in accordance with the latest legislation. It must be disposed of within the electrical and electronic waste stream and not be disposed of in the normal waste stream. Recycling electrical waste products help to conserve natural resources and prevent adverse effects on the environment. Contact your supplier should you require more information.

Declaration of Conformity:

Hereby, Cair (UK) declares that the radio equipment type, Cair Sit/Sleep Advanced is in compliance with Directive 2014/53/EU

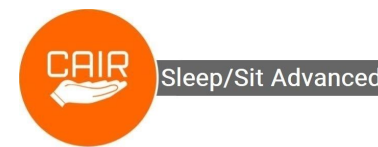

Smart Technology, Made to Care

Sleep Advanced / Sit Advanced

Wireless Bed/Chair Occupancy Sensors

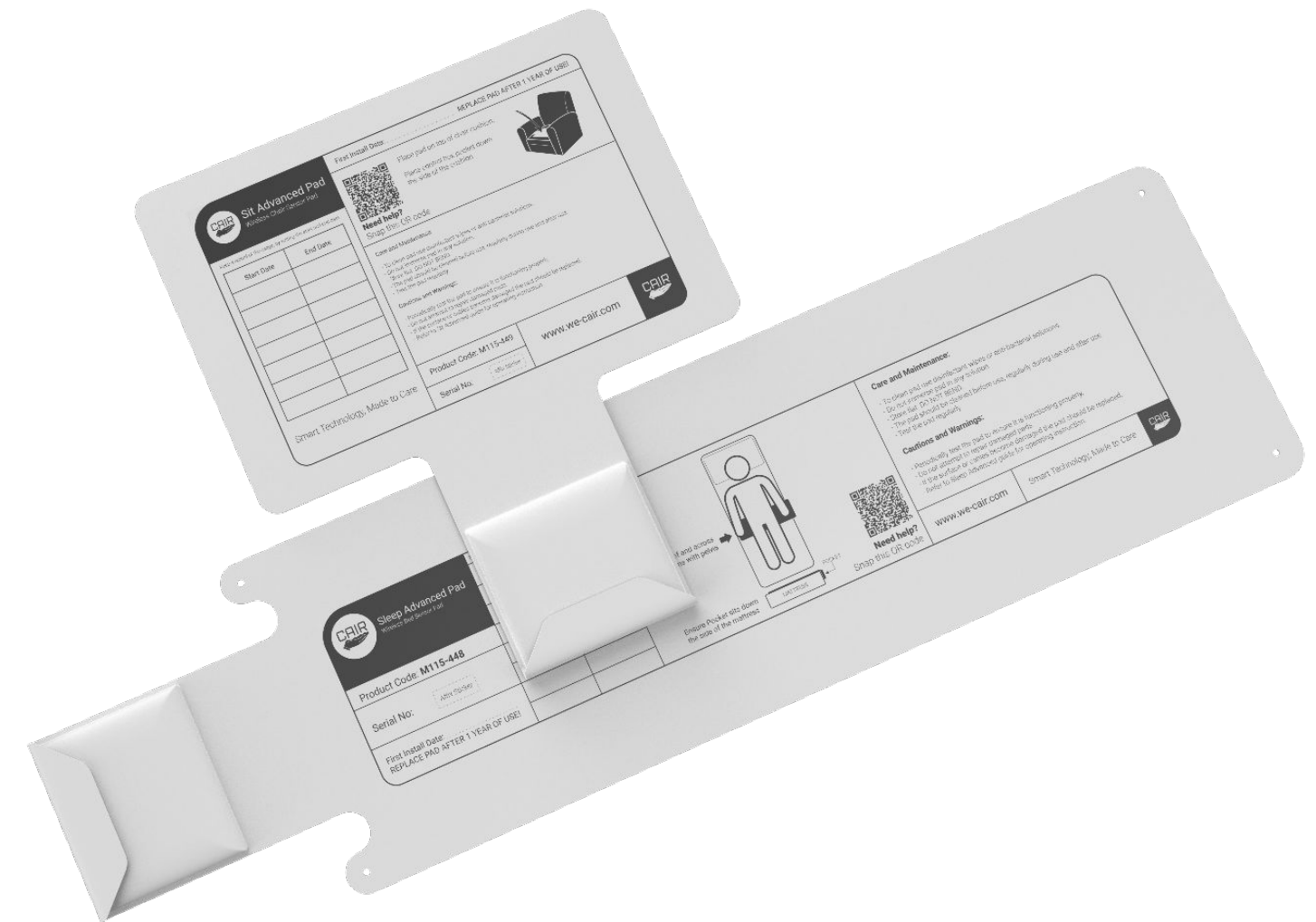

The Sleep Advanced and Sit Advanced are all in one bed/chair occupancy sensors with no visible wires.

Simple and easy to use, the devices contain an occupancy mat and small control unit within a single, wipe clean enclosure. The absence of wires means that the unit is less likely to be tampered with, or accidentally disturbed. Fixing holes in each corner allow the device to be secured if required. Both bed and chair versions are available.



Cair (UK)

Hanson Lane, Halifax, West Yorkshire, HX1 4SD

T: 01422 399 155 E: sales@we-cair.com W: www.we-cair.com

TeleAlarm

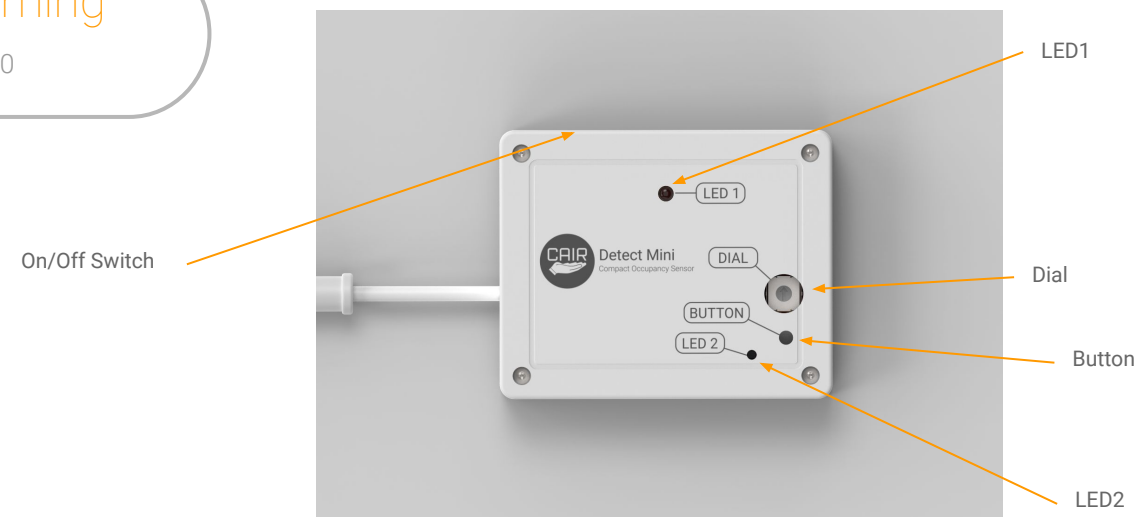

Introduction

The Sleep Advanced and Sit Advanced are all in one bed/chair occupancy sensors with no visible wires. Simple and easy to use, the devices contain an occupancy mat and small control unit within a single, wipe clean enclosure. The absence of wires means that the unit is less likely to be tampered with, or accidentally disturbed. Fixing holes in each corner allow the device to be secured if required. Both bed and chair versions are available.

Operation

The device consists of a bed or chair sensor with a pocket to house a small control unit called the Detect Mini. The sensor should be positioned with the flat part of the mat on top of the bed or chair with the Detect Mini pocket folded down the side of the mattress or chair cushion. The Detect Mini will become active when weight has been applied to the bed/chair pad for more than 3 seconds. LED1 will illuminate during this period. When weight is lifted from the pad, a radio signal will be transmitted when the Absence Delay expires. The Detect Mini has an on/off switch, a 10 position dial and a programming button. Two LED indicators aid programming and testing. Follow the instructions below and overleaf on how to use and program the Detect Mini.

Assigning the Detect Mini to a Notifier or other receiving system

3 identities are used:

- Mode 1: Identity 1
- Mode 2: Weight applied, Identity 2 (Entry). Weight removed, Identity 1 (Exit)
- Mode 3: Enuresis sensor identity 3
- Mode 4: Pressure mat identity 2
- Mode 5: 'Aim' identity 2

1. Program the Detect Mini to either Mode 1 or 2 (Mode 1 is default).
2. Sit on the pad.
3. Prepare the Notifier/other system by entering registration mode.
4. Activate the Detect Mini by vacating the pad. **Tip:** A short absence delay time is ideal for this.
5. The Notifier/other system should acknowledge the new device.

Programming the Modes/Options

To program the modes/options, use the following method:

1. Turn the dial to the desired setting.
2. Press the button momentarily using a suitable instrument. LED2 will flash green when the button is pressed.
3. When the button is released, LED2 will flash a number of times to confirm the chosen mode/option number.
4. Set the absence delay as described below.

Absence Delay

Once the modes/options have been programmed, simply turn the dial to the desired number which matches the delay time required. There is no need to press the button afterwards. The absence delay time settings are:

0 – 0.5 Second	5 – 5 Minutes
1 – 3 Seconds	6 – 15 Minutes
2 – 5 Seconds	7 – 30 Minutes
3 – 20 Seconds	8 – 45 Minutes
4 – 1 Minute	9 – 60 Minutes

Modes/Options

The Detect Mini is easily programmed using the dial positioned within the battery compartment. The dial is numbered 0-9. Each mode/option is explained below:

**Mode 1.** Bed/Chair Absence (Default). When the pad is vacated, a radio message will be sent after the delay time expires. **Note:** The pad must detect presence for 3 seconds before the system becomes active.

**Mode 2.** Virtual Bed/Chair. A radio message will be sent when the pad detects presence **and** when vacated, after the delay time expires. **Note:** The pad must detect presence for 3 seconds before the system becomes active.

**Mode 3.** Enuresis Mode. If the Detect Mini is used with an enuresis mat, an Enuresis radio message will be sent 3 seconds after the mat detects moisture.

**Mode 4.** Pressure Mat Mode. If the Detect Mini is used with a pressure mat, a Pressure Mat radio message will be sent immediately when the mat detects pressure.

**Mode 5.** 'Aim' Mode. The Detect Mini will become active when weight is applied to the bed/chair pad and a radio signal will also be transmitted. This transmission will then be repeated, for up to 24 hours whilst the weight is still applied. The operation may be terminated, before 24 hours, by removing weight from the pad.

**Option 9.** Factory Default. This method resets the unit to Mode 1

1. Choose 9 on dial.
2. Press and release the button momentarily.
3. LED2 will flash 9 times.
4. LED2 will then flash red/green alternately.
5. Whilst LED2 is flashing red/green, press the button 3 times.
6. If factory default is successful, LED2 will illuminate amber while the factory reset is performed.

**Note** It is not possible to change modes while the Delay timer or Repeats or 'Aim' mode is active. **Tip:** It is good practice to default the Detect Mini to factory settings if it has been used previously.

Repeating Alerts

The Detect Mini can send repeating radio messages every 2 minutes after the bed or chair is vacated. This is useful to gauge whether someone has left the bed/chair briefly, or if it is unoccupied for a longer period. If the bed/chair becomes occupied again, the repeating alerts will stop.

To program a repeating alert, turn the dial to the desired number of repeats then press and hold the button for 7 seconds until LED2 illuminates red. Positions 1-9 correspond directly with the number of repeats. Position 0 will switch repeats off (default).

1. Choose 0-9 on dial.
2. Press and hold the button for 7 seconds until LED2 illuminates red, then release the button.
3. LED2 will flash amber to indicate the number of programmed repeats.

**Note:** The number of repeats selected is the amount of repeated alerts in addition to the initial alert. E.g. Two repeats will produce three alerts in total.

Programming Example:

To program the following:

- Mode 2 (No.2 on dial) (steps 2 & 3 below)
- 3 repeating alerts (No.3 on dial) (steps 4 & 5 below)
- Set the absence delay to 3 seconds (No.1 on dial) (step 6 below)

Follow these steps:

1. Reset the unit to factory default if it has been programmed previously (Refer to Option 9 above).
2. Turn the dial to No.2
3. Press the button momentarily using a suitable instrument. LED2 will flash green when the button is pressed and will then flash a further two times to confirm that Mode 2 has been chosen
4. Turn the dial to No.3
5. Press and hold the button for 7 seconds until LED2 illuminates red. Release the button and LED2 will flash amber 3 times to confirm that 3 repeats have been chosen.
6. Turn the dial to No.1 (3 secs absence). There is no need to press the button to program the absence time.