



VB



Smart Technology, Made to Care

Detect

Occupancy Sensor

Programming
Guide v10



The Cair Detect is an intelligent occupancy sensor.

Simple and easy to use, the Detect can be configured as an occupancy and enuresis sensor in one unit. An in-built sounder can provide audio confirmation along with LED indication which provides additional reassurance to users. Two RJ12 terminal inputs are provided for multiple device connections.

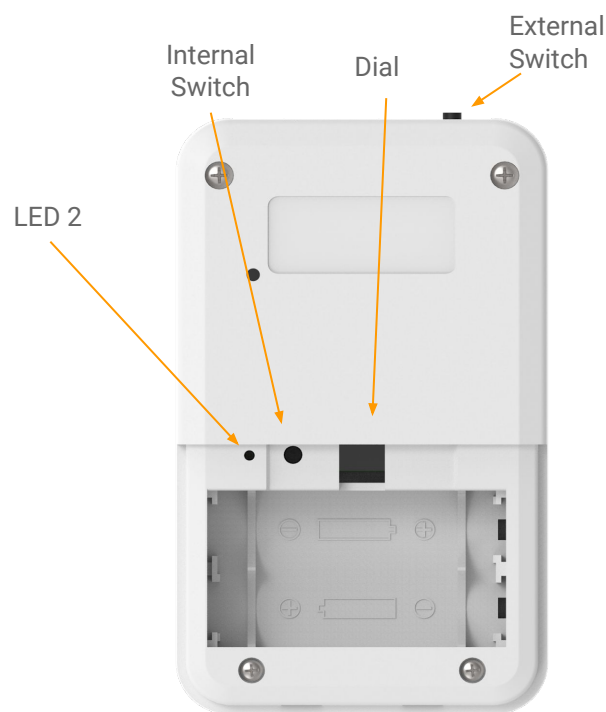
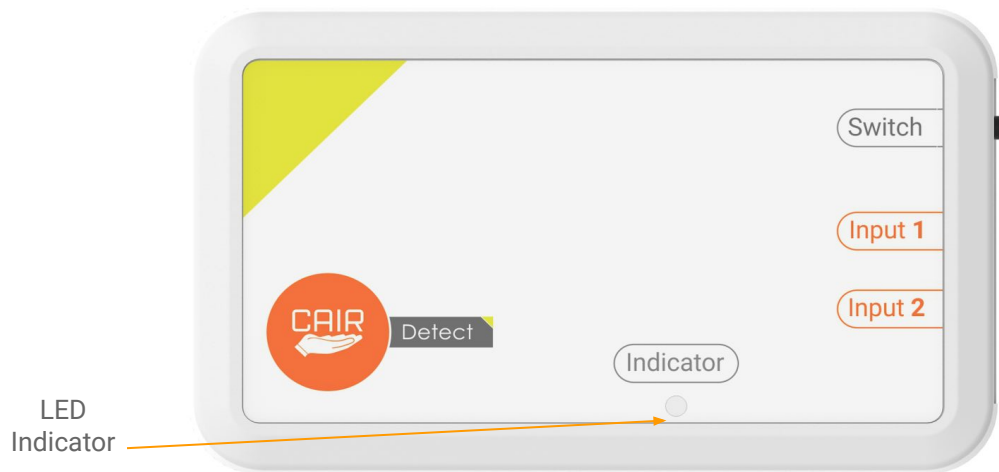

Introduction

The Cair Detect is an intelligent occupancy sensor. Simple and easy to use, the Detect can be configured as an occupancy / enuresis / mat sensor in one unit. An in-built sounder can provide audio confirmation along with LED indication which provides additional reassurance to users. Two RJ12 terminal inputs are provided for external connections. The Detect has many different modes, which are all easily programmable using the dial and internal switch within the battery compartment. **Note:** some RJ11 connections are compatible - contact us for more information,

Operation (Modes 1-4)

When used to monitor bed/chair occupancy sensor, the Detect will become active when weight has been applied to the bed/chair pad for more than 3 seconds. The LED indicator will illuminate during this period. If the sound option (No. 7 on dial) is enabled, a confirmatory beep will be heard after 3 seconds. When weight is lifted from the pad, a radio signal will be transmitted when the Absence Delay expires. In normal use, the Detect should be positioned safely on the floor below or behind the bed/chair, or it can be fixed in position using suitable strapping, cable ties etc. Follow the instructions below and overleaf on how to use and program the Detect.

Switching On & Off

To switch on, press and hold the external switch. The LED Indicator will flash red & green and then produce a high-pitched tone followed by a brief green (for On) or red (for Off) flash, which confirms it's current status . Now release the switch.

Assigning the Detect to a Notifier or other receiving system

Three identities are used:

- Mode 1 and 3: Identity 1 for both inputs
- Mode 2 and 4 : Identity 1 for Input 1 and Identity 2 for Input 2
- Mode 5 : Identity 2 for initial activation and Identity 1 for deactivation for both inputs
- Option 8 : Input 1, Identity 3 for Enuresis sensor / Input 2, Identity 2 as normal (similar to mode 4)

1. Program the Detect to the desired Mode/Option (if using modes 1-5, ensure the absence delay is set to a short time).
2. Sit on the bed/chair pad which is connected to Input 1 (ignore this step if using an Enuresis mat).
3. Prepare the Notifier/other system by entering registration mode.
4. Activate the Detect by moving off the bed/chair pad. If using an Enuresis mat, activate it by applying a damp cloth.
5. The Notifier/other system should acknowledge the new device.
6. If using Modes 2 or 4, or Option 8, repeat steps 1-5 and activate the Detect using the pad connected to Input 2.

Tip: When assigning a new device, the Notifier and most other receiving systems stay in 'activate device' mode for only a short period of time. If using the Detect with bed or chair pads, ensure the Absence Delay is set to activate quickly on step 4 above.

Note: If using an Enuresis mat, with Option 8, it must be connected to Input 1.

Absence Delay

Once the modes/options have been programmed, simply turn the dial to the desired number which matches the delay time required. There is no need to press and hold the internal switch afterwards. The absence delay options are:

0 – 0.5 Second	5 – 5 Minutes
1 – 3 Seconds	6 – 15 Minutes
2 – 5 Seconds	7 – 30 Minutes
3 – 20 Seconds	8 – 45 Minutes
4 – 1 Minute	9 – 60 Minutes

Note: These timings will be different on older Detects with serial numbers preceding 22030742 (Year - (22), Month - (03(March))), last four digits are the build number that month). Delays on older Detects were as follows: 0(0.5s), 1(1s), 2(3s), 3(10s), 4(30s), 5(1m), 6(3m), 7(10m), 8(15m), 9(30m)

Modes/Options

The Detect is easily programmed using the dial positioned within the battery compartment. The dial is numbered 0-9, each option is explained below:

No.0. Not used. (Only used for Absence Delay 0.5 secs).

No.1. Mode 1 - Inputs 1 & 2 will transmit the same identity. Both inputs will 'work together', i.e. you can move from the bed to chair and back again without raising a call. When both pads are vacated for longer than the absence delay, the same trigger code will be sent, irrespective of which pad was vacated last.

No.2. Mode 2 - Inputs 1 & 2 will transmit different identities. Both inputs will 'work together', i.e. you can move from bed to chair and back again without raising a call. When both pads are vacated for longer than the absence delay, different trigger codes will be sent, indicating which pad was vacated last. **Note:** Each input must be assigned to the Notifier/other system separately

No.3. Mode 3 - Inputs 1 & 2 will transmit the same identity. Both inputs will work independently of each other.

No.4. Mode 4 - Inputs 1 & 2 will transmit different identities. Both inputs will work independently of each other. **Note:** Each input must be assigned to the Notifier/other system separately. (Default Mode)

No.5. Virtual Mode Option - A radio transmission will be sent when the pad is both occupied (Identity 2) and unoccupied (Identity 1).

No.6. Cancel at Source Option - On/Off (Modes 1-4 only). A radio signal will be transmitted every 2 minutes until the external switch is pressed 3 times. (Default Off)

No.7. Sound Option - On/Off. A sound will be emitted when the occupancy has been confirmed and also when a transmission is sent. (Default Off)

No.8. Enuresis Option - On/Off. Input 1 will send an Enuresis signal of Identity 3. Input 2 will work similar to Mode 4 (Default Off)

No.9. Factory Default. This method resets the unit to mode 4 with all options set to default.

1. Choose 9 on dial.
2. Press and hold the internal switch until LED 2 changes colour from red to amber and a tone is heard.
3. Release the internal switch, the unit will beep 9 times and LED 2 will flash red in sequence.
4. The LED will then flash red/green alternately.
5. Whilst the LED is flashing red/green, press and release the internal switch 3 times.
6. The unit will produce a high pitched tone and the LED will flash green then illuminate amber to confirm reset.

Tip: It is good practice to default the Detect using Mode No.9 if it has been used previously.

Note: Modes 1 and 2, and Option 5 should be used for a single occupant only

Programming the Modes/Options

To program the modes/options, use the following method:

1. Turn the dial to the desired setting
2. Press and hold the internal switch using a suitable instrument until LED 2 changes colour and a sound is heard (approx 2 seconds)
3. Release the internal switch. LED 2 and the sounder will flash/beep to confirm the mode number you have chosen.
4. Repeat steps 1-3 for other modes/options
5. Set the absence delay as described overleaf.

Programming Example

If you would like to:

- Choose Mode 2 (No.2 on dial) (Steps 2 & 3 below)
- Switch the sound off (No.7 on dial) (Steps 4 & 5 below)
- Set the absence delay to 5 seconds (No.2 on dial) (Step 6 below)

Follow these steps:

1. Reset the unit to factory default if it has been programmed previously (Refer to Mode/Option No.9)
2. Turn the dial to No.2
3. Press and hold the internal switch using a suitable instrument until the unit beeps and LED 2 changes from red to amber (approx. 2 seconds). LED 2 and the sounder will flash/beep twice to confirm the mode/option number you have chosen
4. Turn the dial to No.7
5. Press and hold the internal switch using a suitable instrument until the unit beeps and LED 2 changes from red to amber (approx. 2 seconds). LED 2 and the sounder will flash/beep seven times to confirm the mode/option number you have chosen.
6. Turn the dial to No.2 (5 seconds absence).

Specifications

Operating Frequency	869.2125 MHz
Dimensions	H115 x W69 x D28 mm
Input	2 x RJ12 inputs (some RJ11 connections are compatible - contact us for more information)
Selectable Options	Via easy to select rotary dial
Selectable Audio	Option for audio reassurance
Power Supply	AA batteries (User replaceable)
Battery Life	3 years under the following conditions - 5 alarms transmission per day
Wireless Range	Up to 600m line of sight
Compliance	CE / RoHS 2 / RED
Daily Presence Transmission	Every 24 hours
Warranty	24 months

Battery Replacement

It is important that two 'Energizer L91 Ultimate Lithium AA' Batteries (Part no M115-110) should be used to ensure maximum battery life and accurate low battery notifications. Please note the polarity markings within the battery compartment and ensure that the batteries are inserted correctly.

Note: When replacing batteries, it is important to completely drain any residual power before new batteries are inserted. To do this, simply remove the old batteries, press and hold the on/off switch for 5 seconds, release the switch, then insert the new batteries.

Packing for shipment

The equipment containing cells or batteries must be packed in strong rigid packaging and must be secured against movement within the outer packaging to prevent accidental activation. The sender's name and return address must be clearly visible on the outer packaging.

Safety

Do not dismantle or alter the unit. Do not open the case. Indoor use in dry location only.

Disposal

All electronic waste should be disposed of in accordance with the latest legislation.

It must be disposed of within the electrical and electronic waste stream and not be disposed of in the normal waste stream. Recycling electrical waste products help to conserve natural resources and prevent adverse effects on the environment.

Contact your supplier should you require more information.

Declaration of Conformity:

Hereby, Cair (UK) declares that the radio equipment type, Cair Detect is in compliance with Directive 2014/53/EU

